

1- P.KRD.28.1

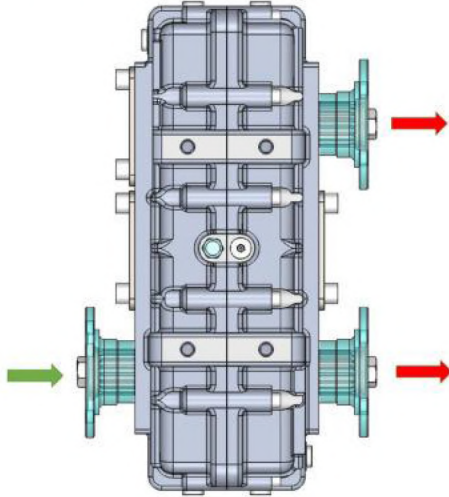

2- P.KRD.28.1.OILP

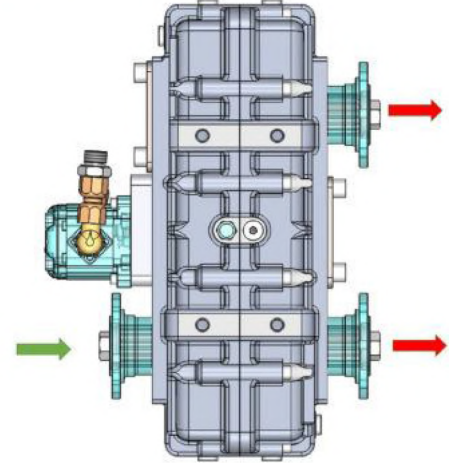

3- P.KRD.28.2

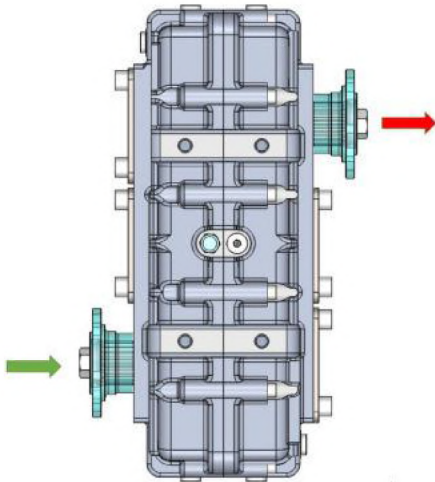

4-P.KRD.28.2.OILP

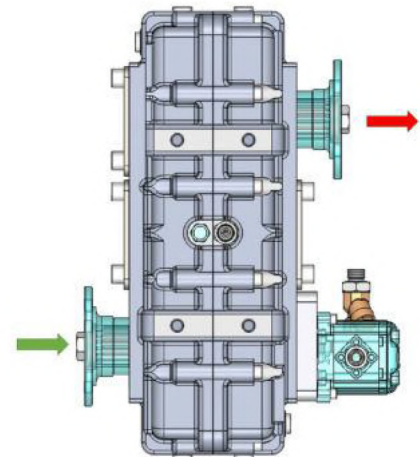

5-P.KRD.28.2.1.OILP

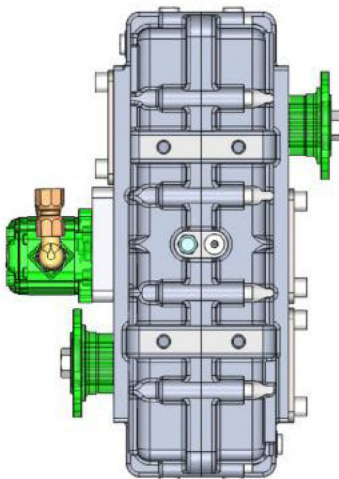

6- P.KRD.28.2.A

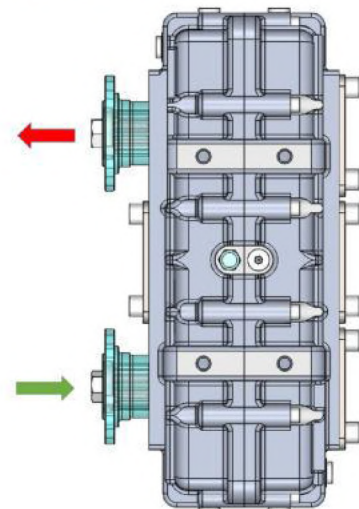

7- P.KRD.28.2.A.OILP

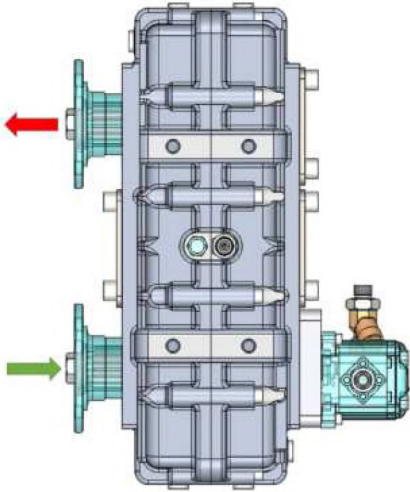

8- P.KRD.28.3

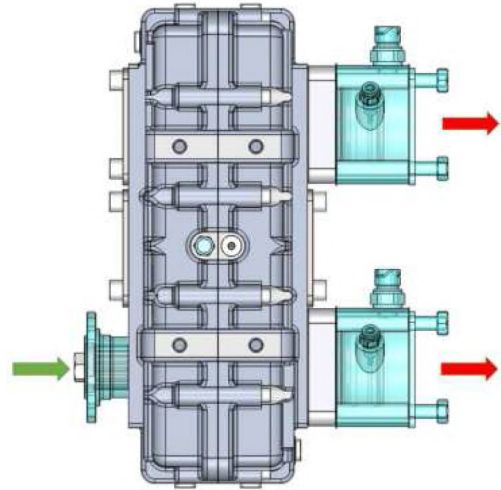

9- P.KRD.28.3.OILP

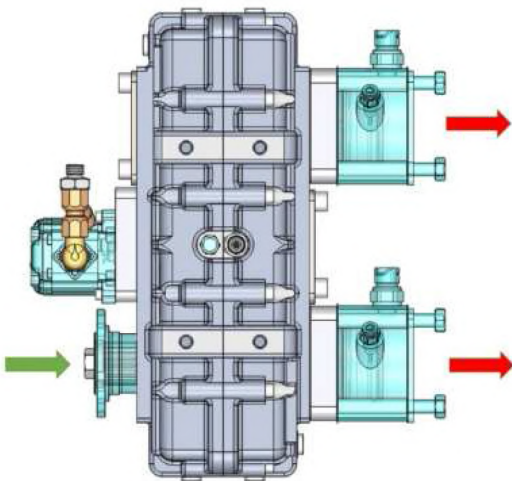

10- P.KRD.28.4.A

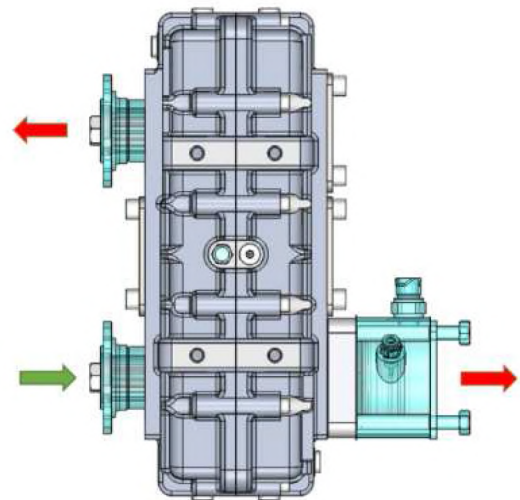

11- P.KRD.28.5.OILP

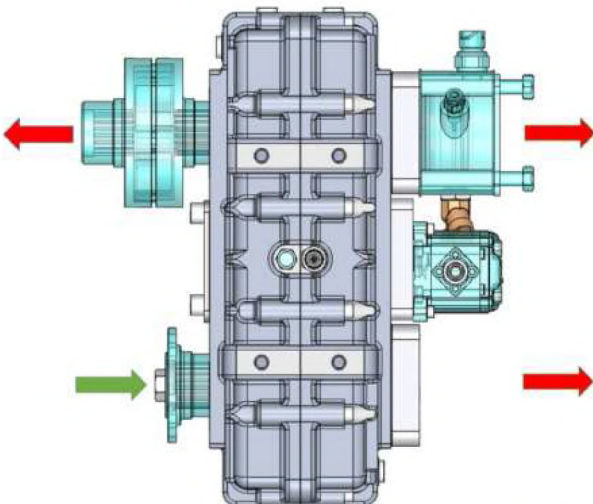

12- P.KRD.28.6

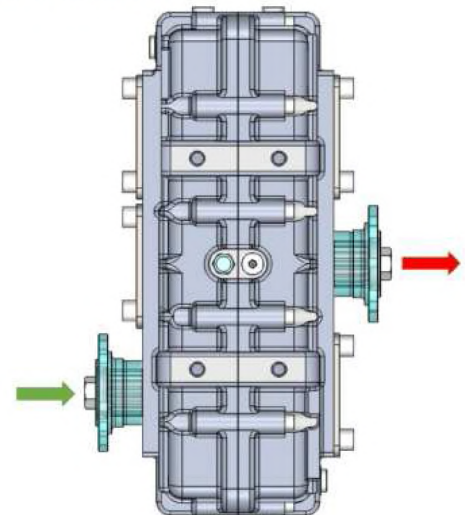



13- P.KRD.28.7

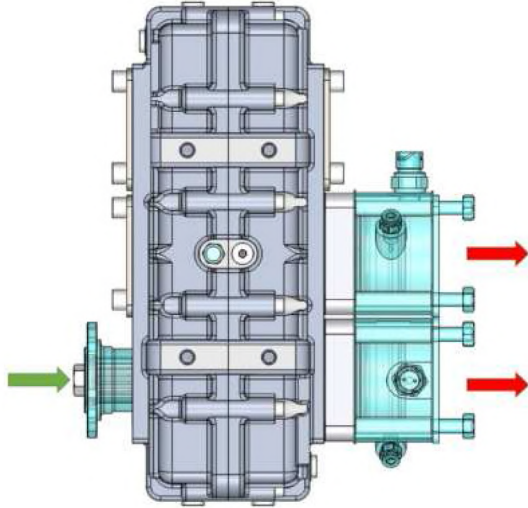

14- P.KRD.28.8

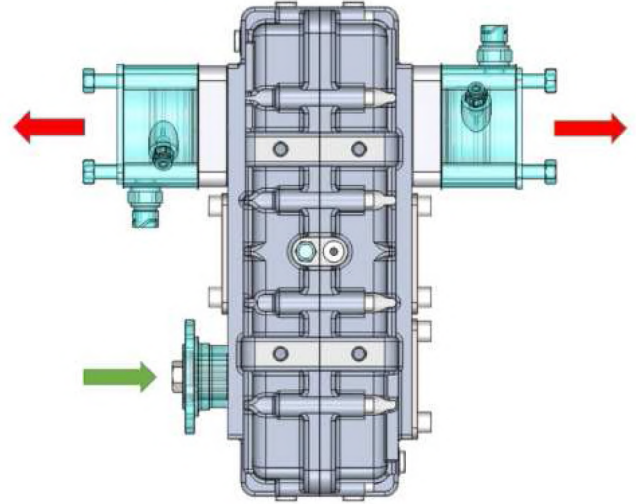

15- P.KRD.28.9.OILP

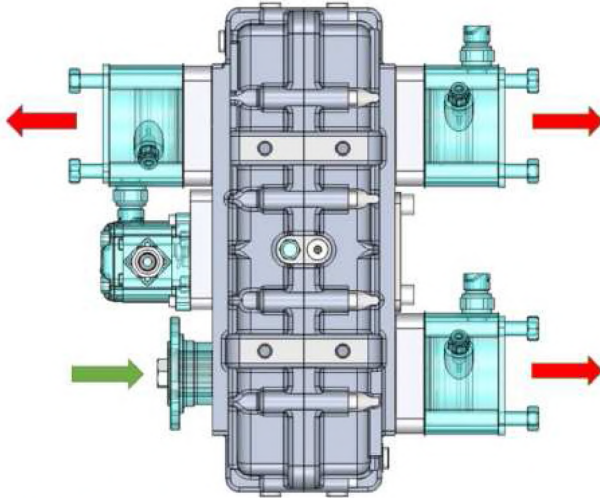

16- P.KRD.28.10.OILP

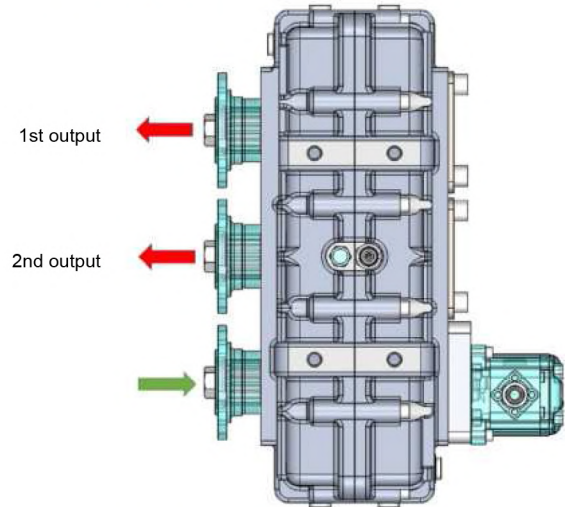

17- P.KRD.28.11.OILP

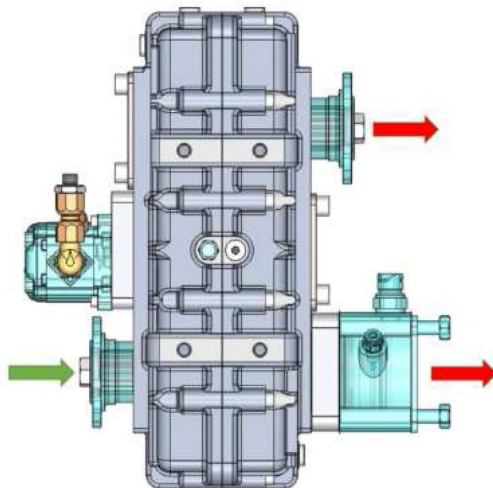

18- P.KRD.28.I

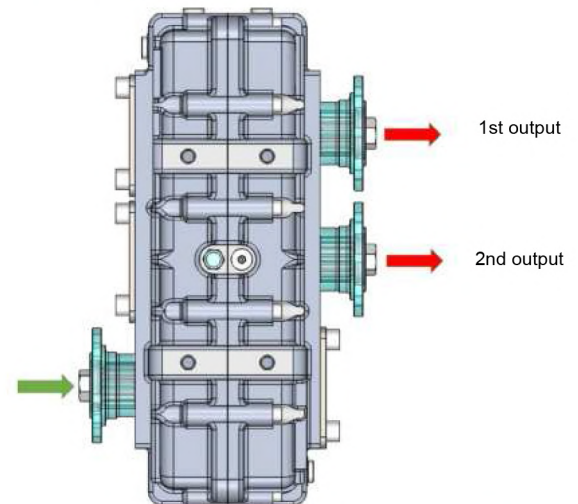

## KRD.28-29-30 Product Configurations

19- P.KRD.28.ISO

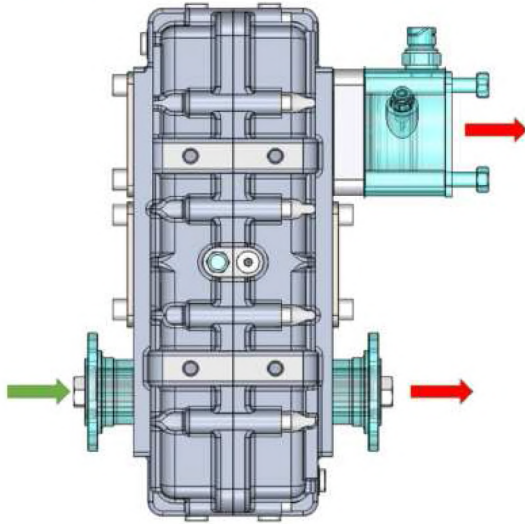

20- P.KRD.28.ISO.OILP

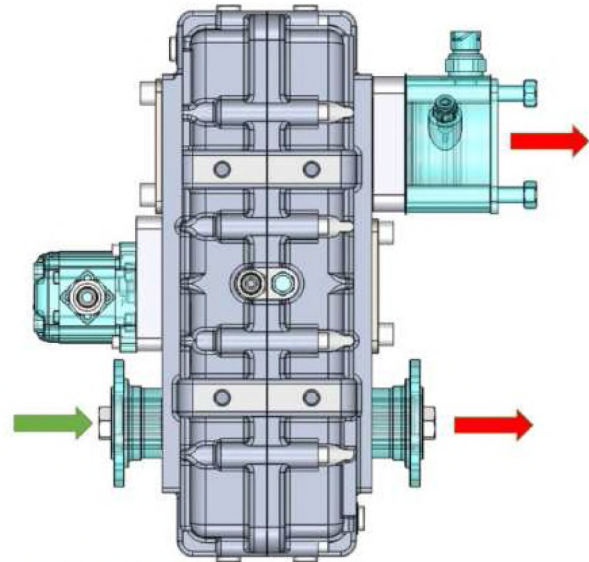

21- P.KRD.29

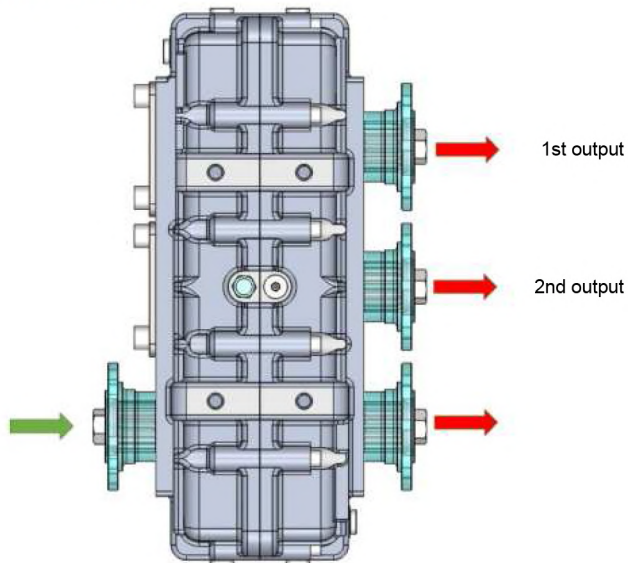

22- P.KRD.30

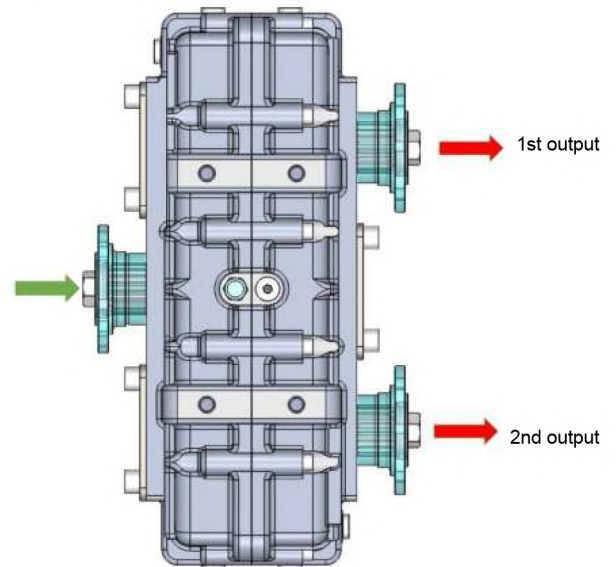

23- P.KRD.30.I

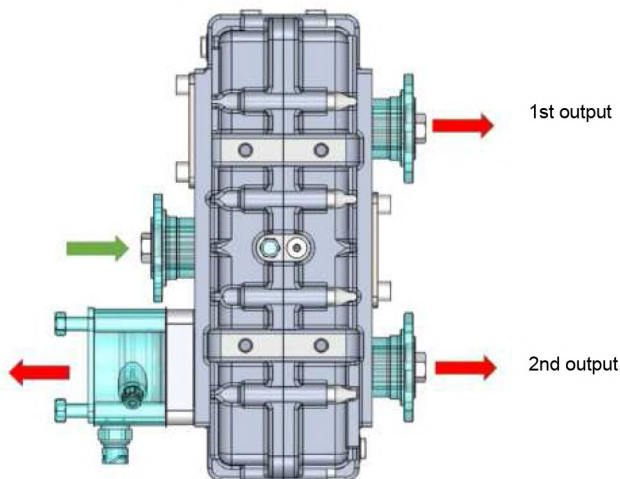

24- P.KRD.30.ISO

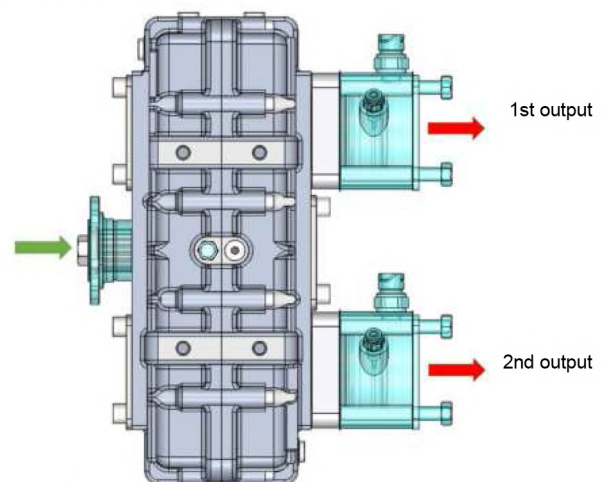



P.D01-06-027 : Body

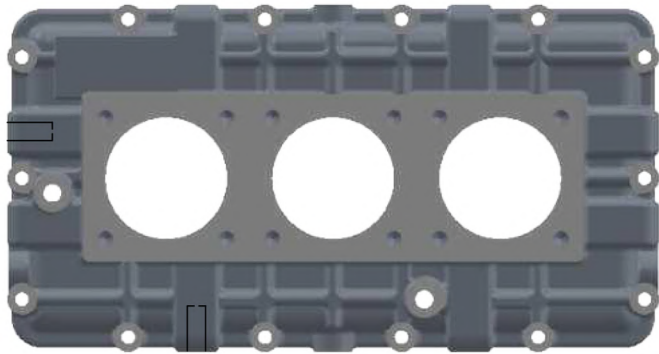

P.D01-06-028 : Cap

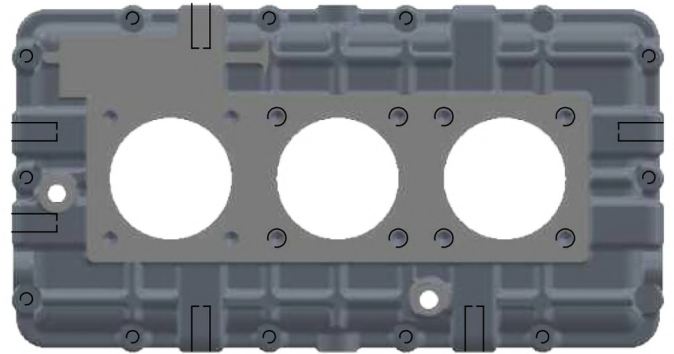

## HORIZONTAL

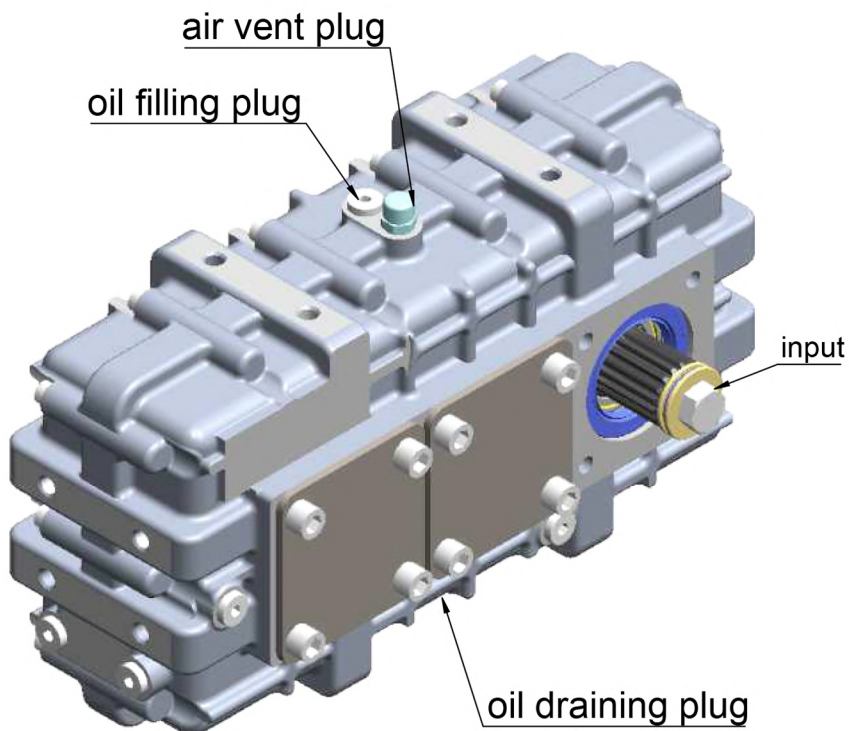

## VERTICAL

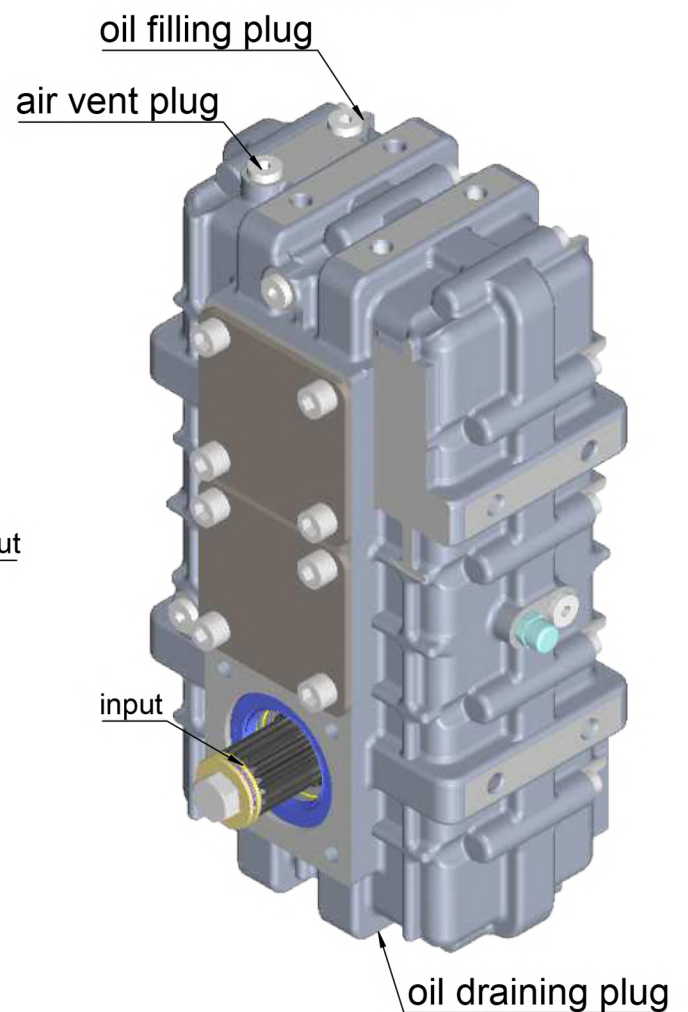

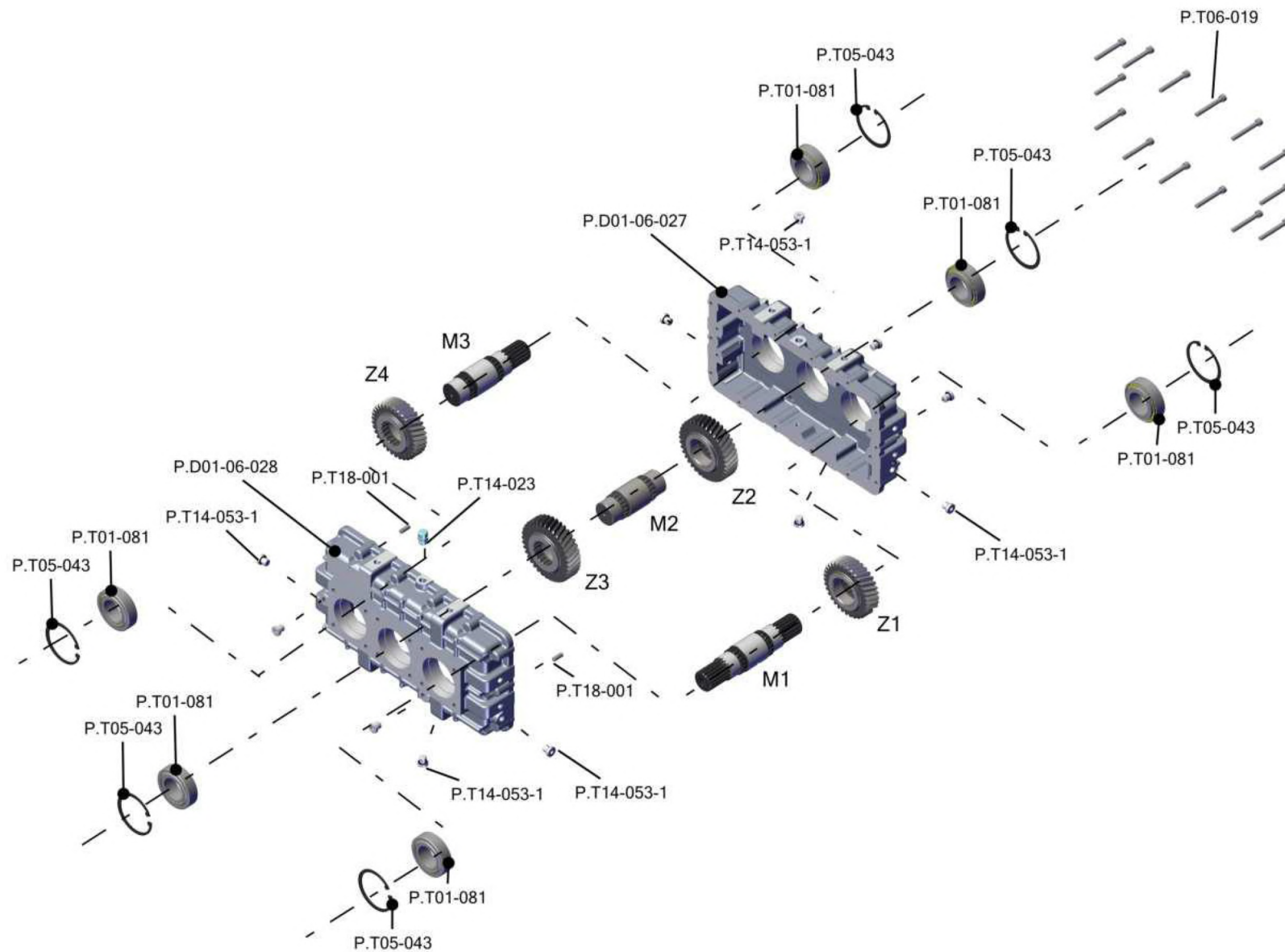

## OUTPUT CONNECTION OPTIONS

Cover

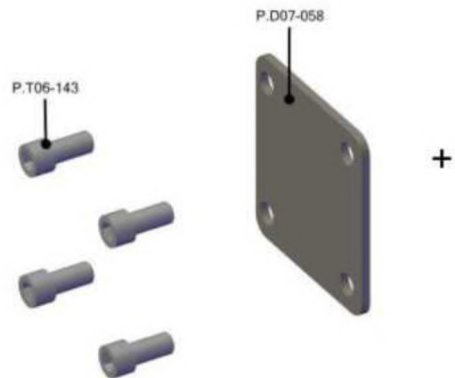

Companion Flange Connection

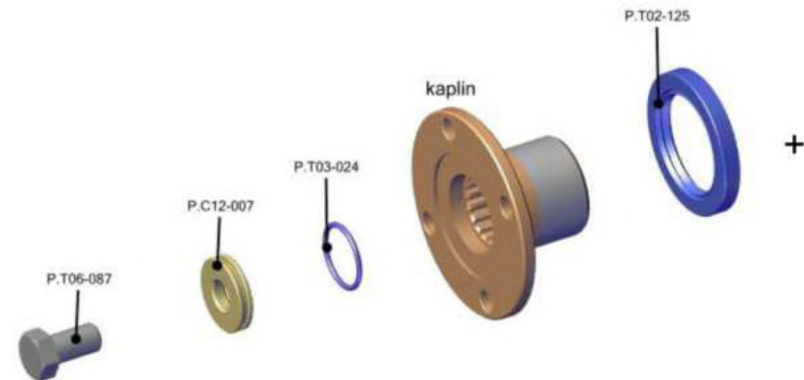

Pneumatic Separator Connection



Lubrication Pump Connection

