

THD-45K

TECHNICAL DRAWING

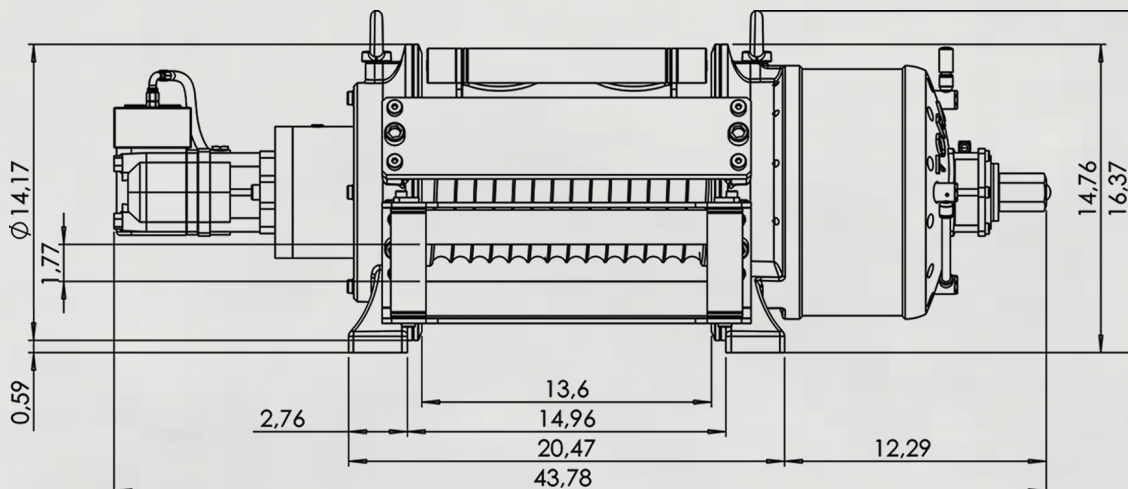

Maximum Pulling Force	45.000 lbs
Rope Diameter	0,78"
Maximum Pump Flow	19 gpm
Maximum Operating Pressure	2465 psi
Recommeded Gear Oil Product	80w 90 - (77 fl-oz.)
Weight	540 lbs
Maximum Rope Lenght	250 ft
Hydromotor	160cc (9.8 ci)
Gear Ratio	48,57 : 1

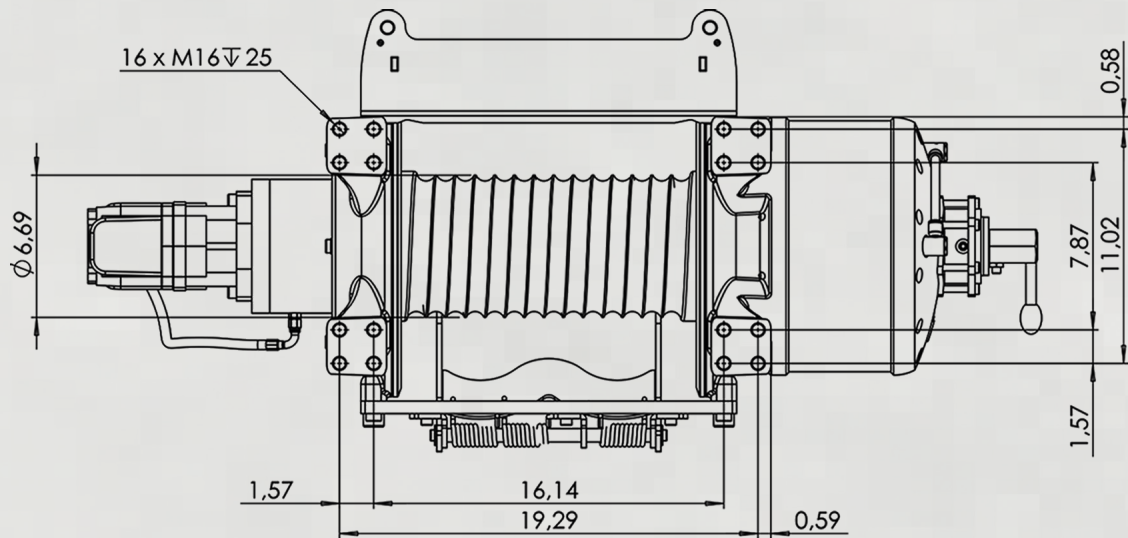
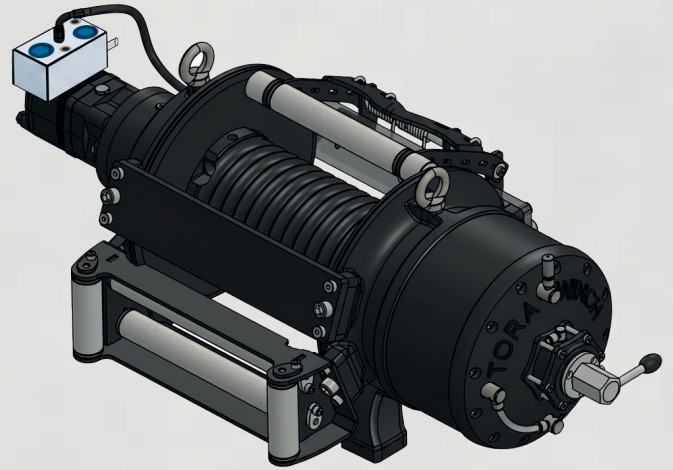
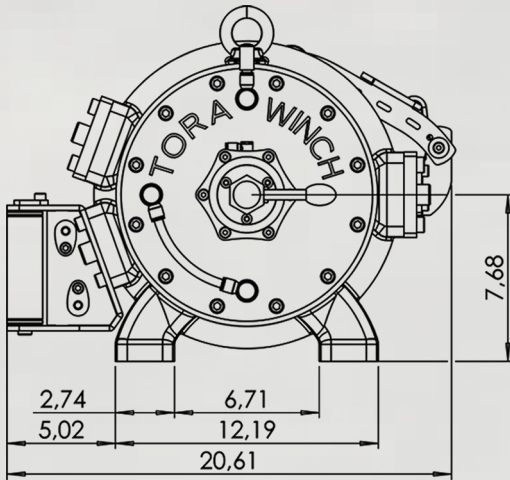
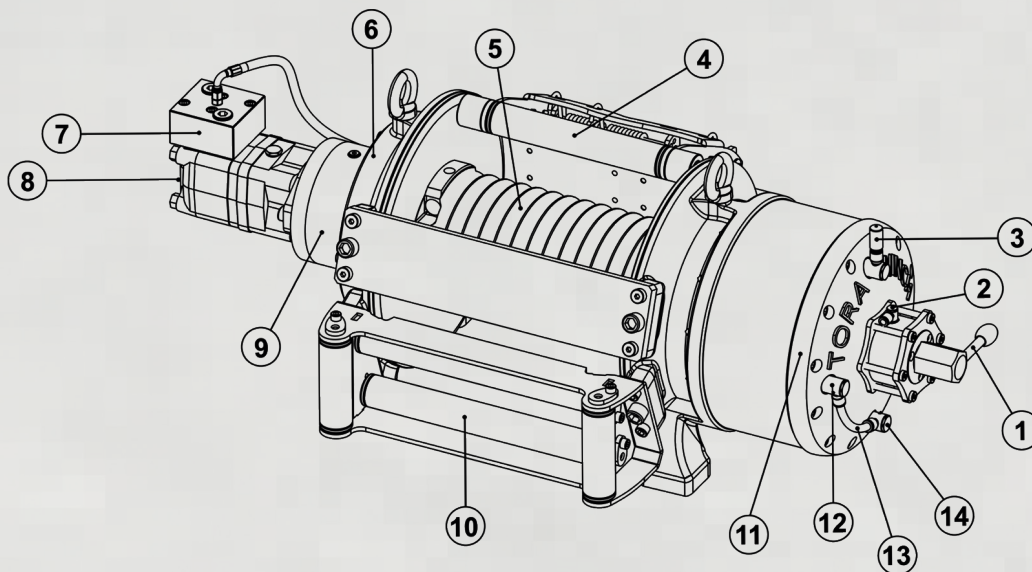
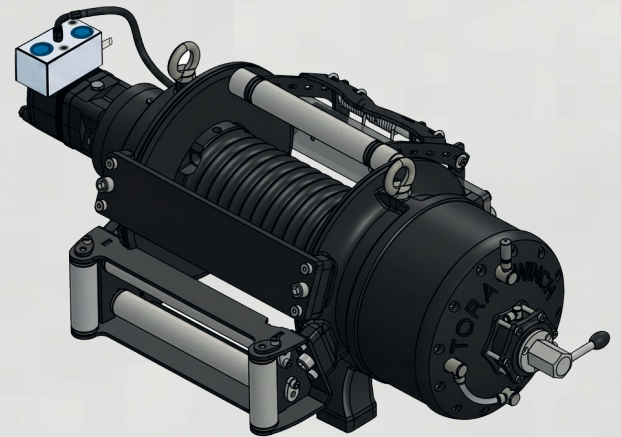

No	Code	Description
1	THD-SP-1	Manual Clutch
2	THD-SP-2	Pneumatic Clutch
3	THD-SP-3	Air Breather & Oil Filling
4	THD-SP-4	Cable Tensioner
5	THD-SP-5	Drum
6	THD-SP-6	Back Cover
7	THD-SP-7	Counter-Balance Valve
8	THD-SP-8	Hydromotor
9	THD-SP-9	Brake Body
10	THD-SP-10	4-Way Roller Fairlead
11	THD-SP-11	Gearbox Cover
12	THD-SP-12	Oil Level Plug
13	THD-SP-13	Oil Hose
14	THD-SP-14	Drain Plug

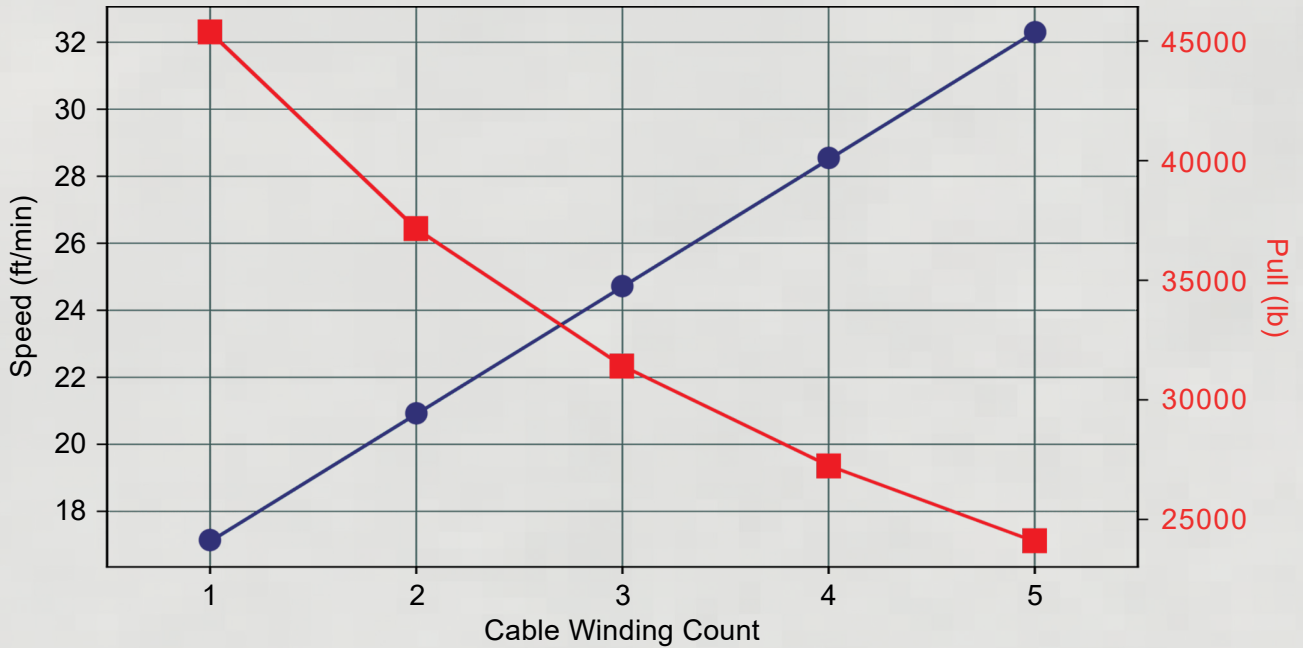
TECHNICAL DATA

**The above values are calculated based on a 19 GPM flow rate , a 9.8 in³/rev hydraulic motor, and an 0,78" diameter cable. Values are calculated for Horizontal Pulling Work*

Rope Winding Count	Pulling Capacity lbs	Winding Speed ft-min	Rope Length ft
1	45000	17,00	30
2	37150	20,90	63
3	31400	24,70	102
4	27250	28,50	148
5	24080	32,30	195

TECHNICAL DRAWING WITH BOTTOM PATTERN

